

PVC EXHAUST FAN RANGE

- Durable PP plastic casing structure
- High quality motor and air delivery
- Including rubber fastner for quick mounting
- Compliance with CE, CB and ESMA standards

Ventilating Fan

- Window mounted pull rope type rear baffle design, can prevent outdoor air flow
- New design panel, large air volume, low noise
- Simple structure, easy to install
- The motor is made of steel sheet and all copper. The service life is provided with over-heat protector
- So it's safer to use



Figure 59.1

Ventilating Fan

- The blades are designed with six blades for high air volume and low noise
- Automatic stop louvers to prevent mosquitoes from entering
- Oil sink of front panel is easy to disassemble and easy to clean
- The motor is made of silicon steel sheet and copper material for long service life
- Configure the overheat protector for safer use



Figure 59.2

Model	Size		Watts	Voltage	Frequency	RPM	Air Volume	Image Code
	inch	mm						
LTX6R	6	150	15W	220-240V	50 Hz	1900	260	Figure 59.1
LTX8R	8	200	25W	220-240V	50 Hz	1800	420	Figure 59.1
LTX6S	6	150	20W	220-240V	50 Hz	1400	290	Figure 59.2
LTX8S	8	200	28W	220-240V	50 Hz	1300	480	Figure 59.2

Ventilating Fan

- Window mounted high power ventilating fan with air pressure shutter
- Propeller fan incorporated with advanced blade design
- New design panel, large air volume, low noise
- The motor is made of steel sheet and all copper provided with over-heat protector
- Powerful long life bush bearing motor

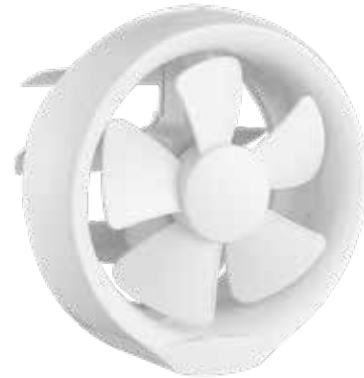

Figure 60.1

Ventilating Fan

- Super slim ceiling mounted design with air pressure shutter
- 7 blade design for high air volume and low noise on operation
- Back louver to avoid air and mosquito come indoors
- The motor is made of silicon steel sheet and copper material for long service life
- Built-in thermal cut-out protector for safer use



Figure 60.2

Model	Size		Watts	Voltage	Frequency	RPM	Air Volume	Image Code
	inch	mm				r/min		
LTX6RA	6	150	15W	220-240V	50 Hz	1700	260	Figure 60.1
LTX6RC	6	150	17W	220-240V	50 Hz	1550	290	Figure 60.2

| Ventilating Fan



PVC VENTILATING RANGE

- Perfect models for indoor ceiling / wall exhaust application
- High quality motor with PP plastic housing
- Premium safety standard
- Compliance with CE and CB standards

Ventilating Fan



Features

- Unique design wall mounted exhaust fan and top grade PP plastic structure
- Easy installation, simple and can be installed indoors
- The motor is made of silicon steel sheet and copper material for long service life
- Built-in thermal cut-out protector for safer use
- Electrical back non-return shutter to avoid air and mosquito come indoors which is suitable for high-rise buildings

Application : Bathroom | Kitchen | Bedroom | Office

Voltage : 220-240V 50HZ

Specifications

Model	Size		Power	Air Volume	RPM	Noise	Packing Size	Qty	Net Weight
	mm	in	W	m ³ /Hr	r/min	dB(A)	cm	PCS	kg
Y-EXA-15P	150	6	24	216	1350	42	71.8x25.1x39	6	2
Y-EXA-20P	200	8	28	432	1280	45	61.2x31.8x40.9	4	2.75

Dimension (mm)

Model	A	B	C	D	Hole Size
	mm				
Y-EXA-15P	224	176	100	69	Ø 187
Y-EXA-20P	288	238	104	72	Ø 249

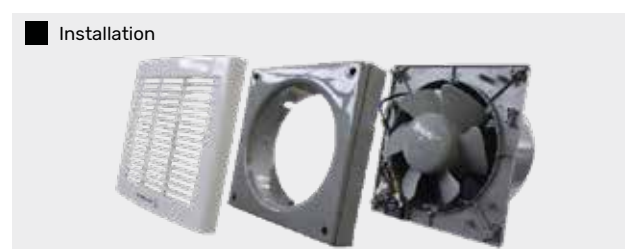
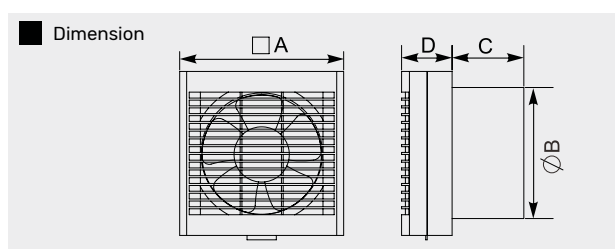

Ventilating Fan

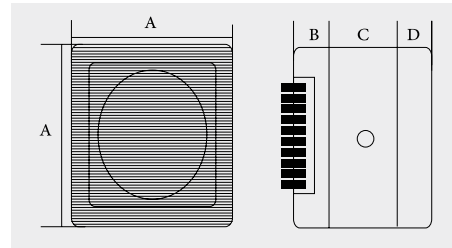

Application : Bathroom | Kitchen | Bedroom | Office
Voltage : 220-240V 50HZ

Features

- Elegant square box window mounted design with auto electric shutter
- Silicon steel motor with built-in therm-cut-off protection
- Big airflow and quiet noise
- The motor is made of silicon steel sheet and copper material for long service life

Model	Size		Power W	Air Volume m ³ /Hr	RPM r/min	Noise dB(A)	Diamention (AxBxC) mm	Qty PCS	Net Weight kg
	mm	in							
Y-EXSQ-15	150	6	25	250	1900	37	210x56x38	10	1.146

Ventilating Fan

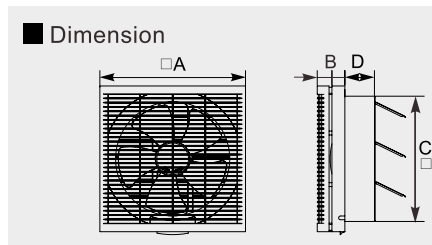

Application : Bathroom | Kitchen | Bedroom | Office
Voltage : 220-240V 50HZ

Features

- Window mounted high power ventilating fan with air pressure shutter
- The blades are designed with five blades for high air volume and low noise
- Automatic stop louvers to prevent mosquitoes from entering
- The motor is made of silicon steel sheet and copper material for long service life
- Configure the overheat protector for safer use

Model	Size		Power W	Air Volume m ³ /Hr	RPM r/min	Noise dB(A)	Diamention (AxBxC) mm	Qty PCS	Net Weight kg
	mm	in							
Y-EXM-15S	150	6	25	258	1350	40	237x29x194	8	1.6
Y-EXM-20S	200	8	32	486	1250	41	293x33x240	5	2
Y-EXM-25S	250	10	35	750	1200	42	338x36x290	5	2.4
Y-EXM-30S	300	12	47	1200	1050	45	396x40x340	4	3.1

Ventilating Fan

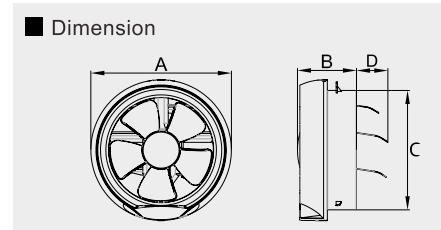

Application : Bathroom | Kitchen | Bedroom | Office
Voltage : 220-240V 50HZ

Features

- Window mounted high power ventilating fan with air pressure shutter
- Propeller fan incorporated with advanced blade design
- New design panel, large air volume, low noise
- Simple structure, easy to install
- The motor is made of steel sheet and all copper. The service life is provided with over-heat protector

Model	Size		Power W	Air Volume m ³ /Hr	RPM r/min	Noise dB(A)	Dimension (AxBxC) mm	Qty PCS	Net Weight kg
	mm	in							
Y-EXP-15	150	6	25	222	1900	43	210x82x176	12	1.1
Y-EXP-20	200	8	32	380	1320	42	272x103x239	8	1.6

Ventilating Fan

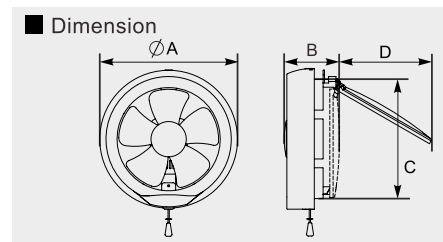

Application : Bathroom | Kitchen | Bedroom | Office
Voltage : 220-240V 50HZ

Features

- Pull rope type rear baffle design, can prevent outdoor air flow, mosquito enter
- New design panel, large air volume, low noise
- Simple structure, easy to install
- The motor is made of steel sheet and all copper. The service life is provided with over-heat protector

Model	Size		Power W	Air Volume m ³ /Hr	RPM r/min	Noise dB(A)	Dimension (AxBxC) mm	Qty PCS	Net Weight kg
	mm	in							
Y-EXR-15	150	6	15	300	1980	33	206x82x176	18	0.9
Y-EXR-20	200	8	25	480	1920	37	272x103x238	10	1.5

Ventilating Fan

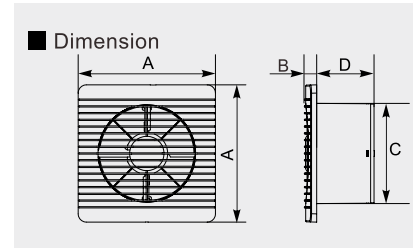

Features

- Super slim ceiling mounted panel design
- 7 Blade design for high air volume and low noise on operation
- Butterfly type back louver to avoid air and mosquito come indoors
- The motor is made of silicon steel sheet and copper material for long service life
- Built-in thermal cut-out protector for safer use

Application : Bathroom | Kitchen | Bedroom | Office

Voltage : 220-240V 50HZ

Model	Size		Power	Air Volume	RPM	Noise	Diamension (AxBxC)	Qty	Net Weight
	mm	in							
Y-EXS-10	100	4	15	80	2450	33	161x22x98	20	0.44
Y-EXS-15	150	6	25	250	1900	37	209x22x148	20	0.69

Ventilating Fan

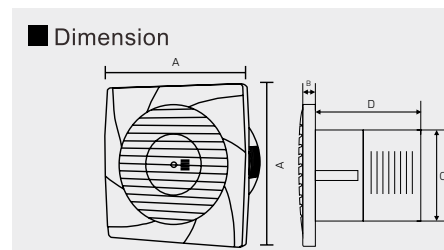

Features

- High power ceiling mounted design
- 7 Blade design for high air volume and low noise on operation
- Butterfly type back louver to avoid air and mosquito come indoors
- The motor is made of silicon steel sheet and copper material for long service life
- Built-in thermal cut-out protector for safer use

Application : Bathroom | Kitchen | Bedroom | Office

Voltage : 220-240V 50HZ

Model	Size		Power	Air Volume	RPM	Noise	Diamension (AxBxC)	Qty	Net Weight
	mm	in							
Y-EXC-15	150	6	25	250	1900	37	209x13x148	20	0.71
Y-EXC-20	200	8	25	370	1600	39	276x8x198	6	1.45